

The New Student Hub (in SharePoint)

- **Brings all your course sites together** in one place
- Provides you with links to your email, timetable and homework
- In the future:
 - Information and access to help and support resources
 - News and information

How to find the site 1

- Here's the link:
<https://smrtschool.sharepoint.com/sites/TheStudentHub>
- The link is available on the school website under **Quicklinks**

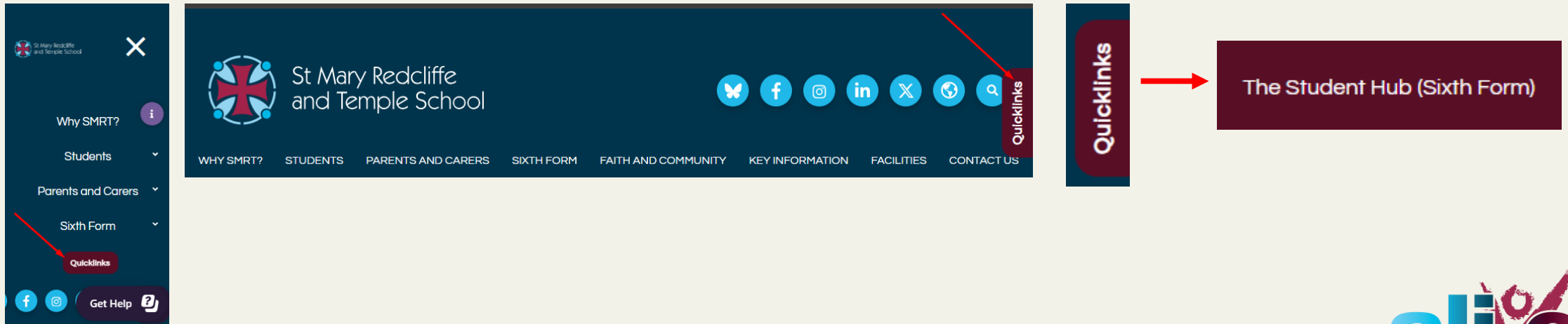

How to find the site 2

- The link is in your **Start Menu** on the School PCs here:

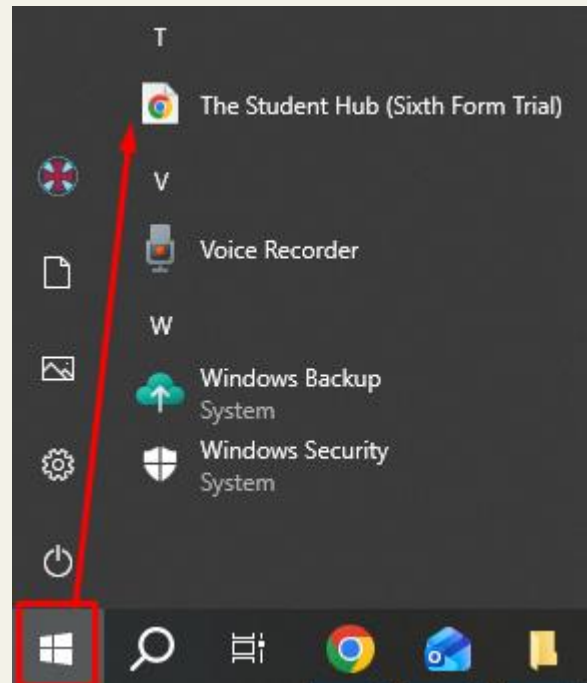

How to find the site 3

- In SharePoint, the link is listed as a **Featured Link** (desktop and the SharePoint app)

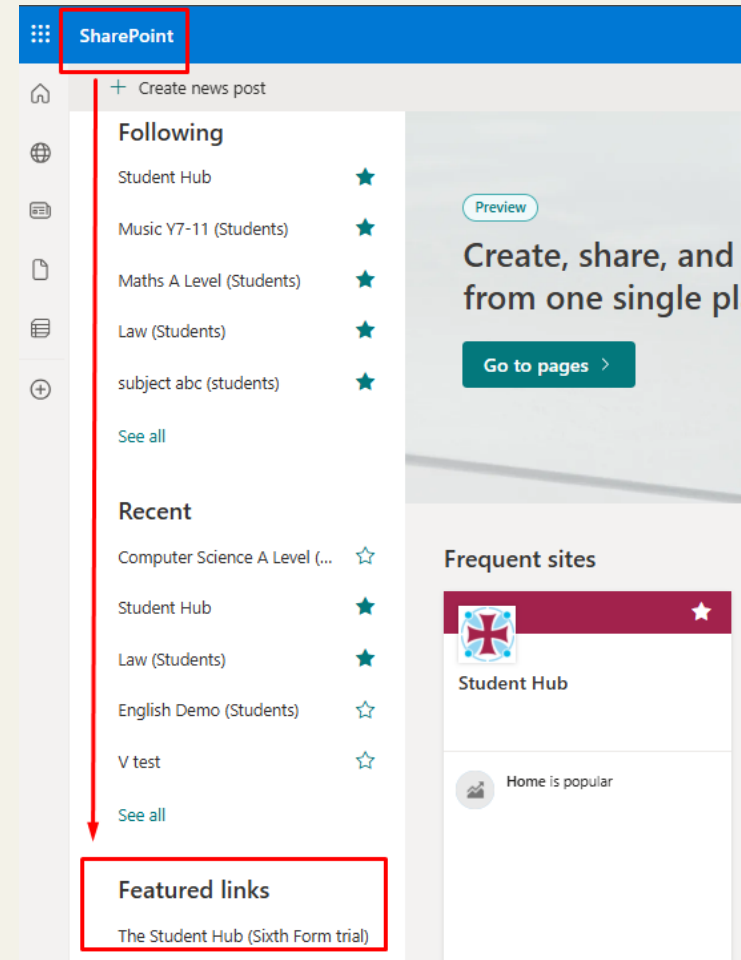

Simple to use

- Your subjects will appear in the header menu and as tiles*

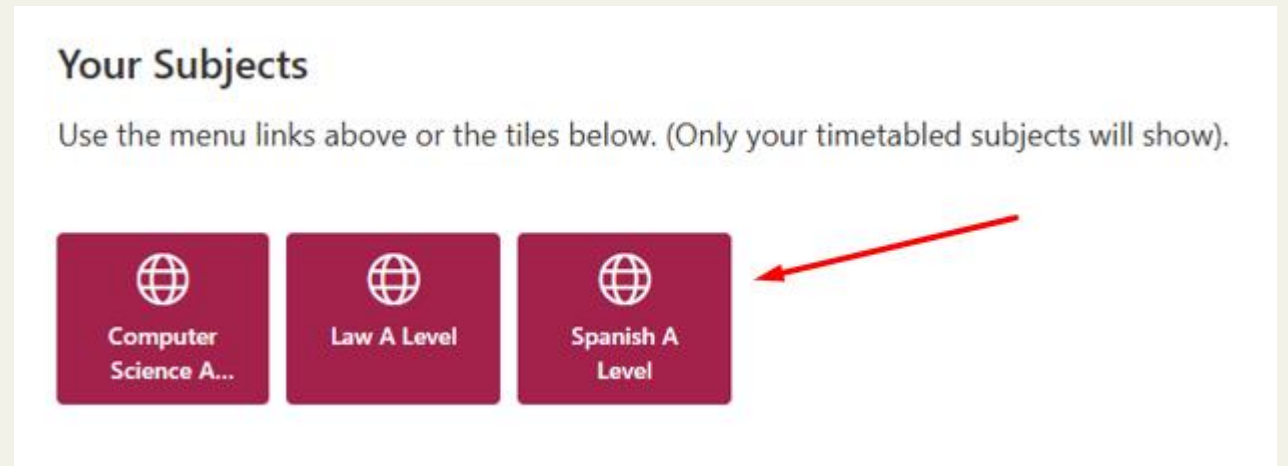
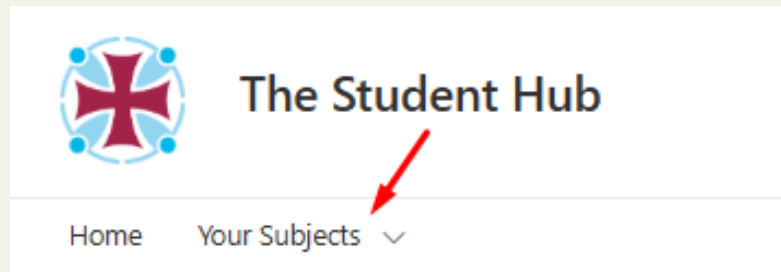

* If your subject is missing, please speak to your subject teacher in the first instance. They may contact the Tech Support team or ask you to

Simple to use

- Further down the page you will find links to your **timetable**, **email** and **homework**

Your Support Dashboard

See below for a range of support information for you. If you can't find what you are looking for, speak to your tutor in the first instance.

Your Timetable

Student Portal - use the Microsoft login button

[Learn more](#)

Your Email

Login with your School email and password

[Learn more](#)

Your Homework

Student Portal - use the Microsoft login button

[Learn more](#)

Recommendations – do both

- **FOLLOW** the site in SharePoint by clicking the Follow Star at the top of the site page or next to the site name in the SharePoint App

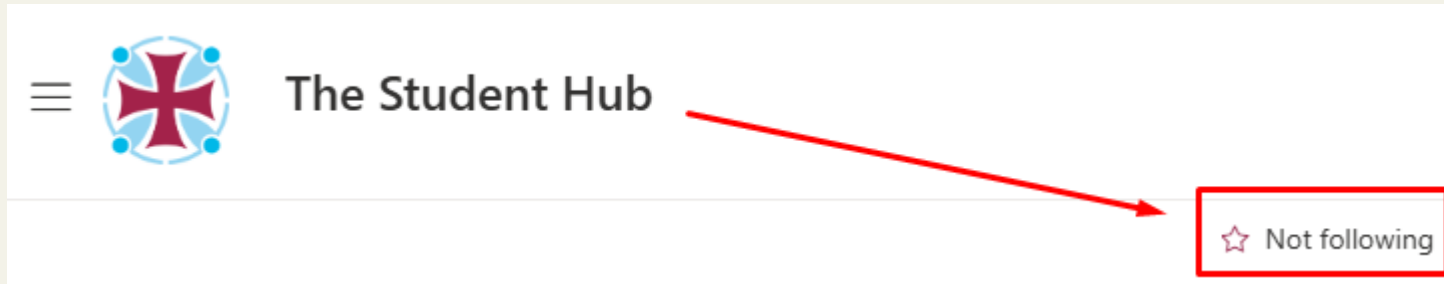

- **BOOKMARK** the site in your phone & PC/Laptop/Tablet browser